

## **LINE PRODUCTION MIXER DRUM PADDLES**



### **TECHNICAL SPECIFICATIONS**

- **Material section:** 25 x 6 mm
- **Production:** 4 pieces / min
- **The machine is composed by these unities:** reel arm, straightening station, horizontal bending station, vertical bending station, hydraulic shear station.

*Sheet Metal Men s.r.l.*  
Via Luigi Cazzola, 35/E 36015 Schio (VI) Italy  
Tel. (+39) 0445 315431 Fax. (+39) 0445 319944  
E-mail: [info@sheetmetalmen.it](mailto:info@sheetmetalmen.it) Web: [www.sheetmetalmen.it](http://www.sheetmetalmen.it)

**Straightening station**



**Vertical bending station**



**Hydraulic shear station**



**Paddle with horizontal and vertical bending**

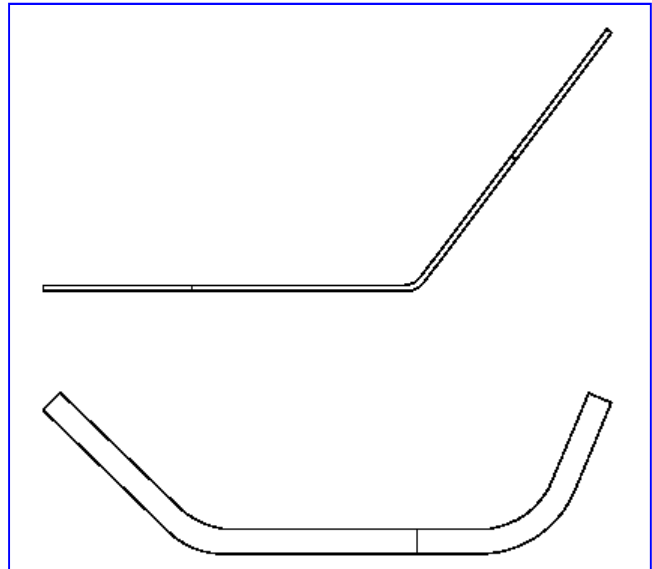

**Mixer**



**Paddle with only horizontal bending**

