

MARBLING MACHINE



TECHNICAL SPECIFICATIONS

- | | |
|------------------------------------|----------------------|
| • Max / min diameter bowls | 1300 / 400 mm |
| • Max / min height bowls | 800 / 250 mm |
| • Max force wire brush | 100 kg |
| • Stroke wire brush | 50 mm |
| • Power motor axis X | 0,18 kW |
| • Power motor axis Y | 0,12 kW |
| • Power motor rotation bowl | 0,75 kW |

Sheet Metal Men s.r.l.
Via Luigi Cazzola, 35/E 36015 Schio (VI) Italy
Tel. (+39) 0445 315431 Fax. (+39) 0445 319944
E-mail: info@sheetmetalmen.it Web: www.sheetmetalmen.it

Motion group



Wire brush



Electric comand



Type of stainless steel bowls

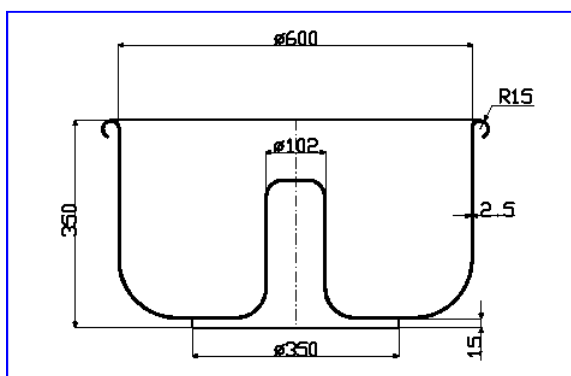
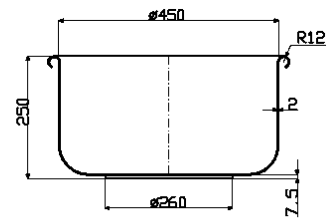
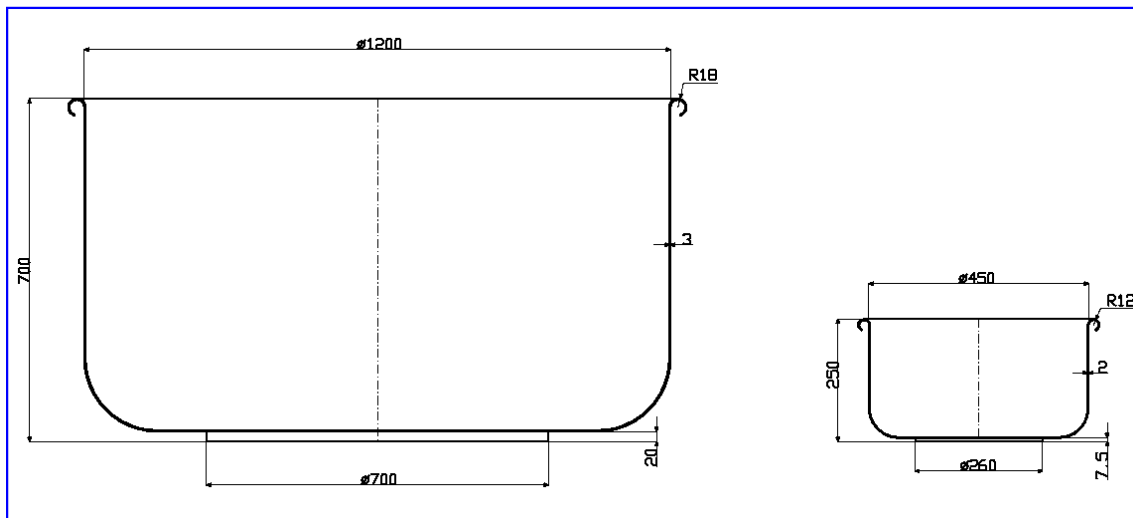

Sheet Metal Men s.r.l.

Via Luigi Cazzola, 35/E 36015 Schio (VI) Italy

Tel. (+39) 0445 315431 Fax. (+39) 0445 319944

E-mail: info@sheetmetalmen.it Web: www.sheetmetalmen.it